

INDUSTRIAL SPACE FOR SALE/LEASE NEAR ST. JAMES INDUSTRIAL



# 1373 SPRUCE STREET

## WINNIPEG, MB



### CONTACT

**ERIC OTT**, Vice President, Sales & Leasing

(204) 985-1378

[eric.ott@capitalgrp.ca](mailto:eric.ott@capitalgrp.ca)

*Services provided by Eric A. Ott Personal Real Estate Corporation*

**MARIO POSILLIPO**, Senior Advisor, Sales & Leasing

(204) 985-1373

[mario.posillipo@capitalgrp.ca](mailto:mario.posillipo@capitalgrp.ca)

# PROPERTY DETAILS

<b>BUILDING AREA (+/-)</b>	16,449 sq. ft.
<b>LAND AREA (+/-)</b>	31,806 sq. ft. (0.73 acres)
<b>SALE PRICE</b>	\$2,350,000.00
<b>NET RENTAL RATE</b>	\$9.95 per sq. ft.
<b>PROPERTY TAX</b>	\$1.49 per sq. ft. (\$24,457.29 for 2025)
<b>TITLE NO.</b>	1536828/1
<b>LEGAL DESCRIPTION</b>	LOT 2 PLAN 25864 WLTO IN OTM LOT 50 PARISH OF ST JAMES
<b>LOADING</b>	(1) Dock (8'x8') & (2) Grade Doors (12'x16' and 8'x10')
<b>ZONING</b>	M2 – Manufacturing – General
<b>CLEAR HEIGHT (+/-)</b>	28' clear in back 4,992 sq. ft. section
<b>ELECTRICAL</b>	400 Amp total service, with a 225 Amp transformer for 600V 3-phase
<b>COLUMNS</b>	Clear span construction in back section
<b>YEAR BUILT</b>	1927 (with a 4,992 SF addition in 2005)
<b>ROLL NO.</b>	13010403000

## HIGHLIGHTS

- Extensive office buildout
- Fully sprinklered
- Versatile loading options (dock & grade)
- Recent upgrades to the front facade enhance curb appeal



# FLOOR PLAN

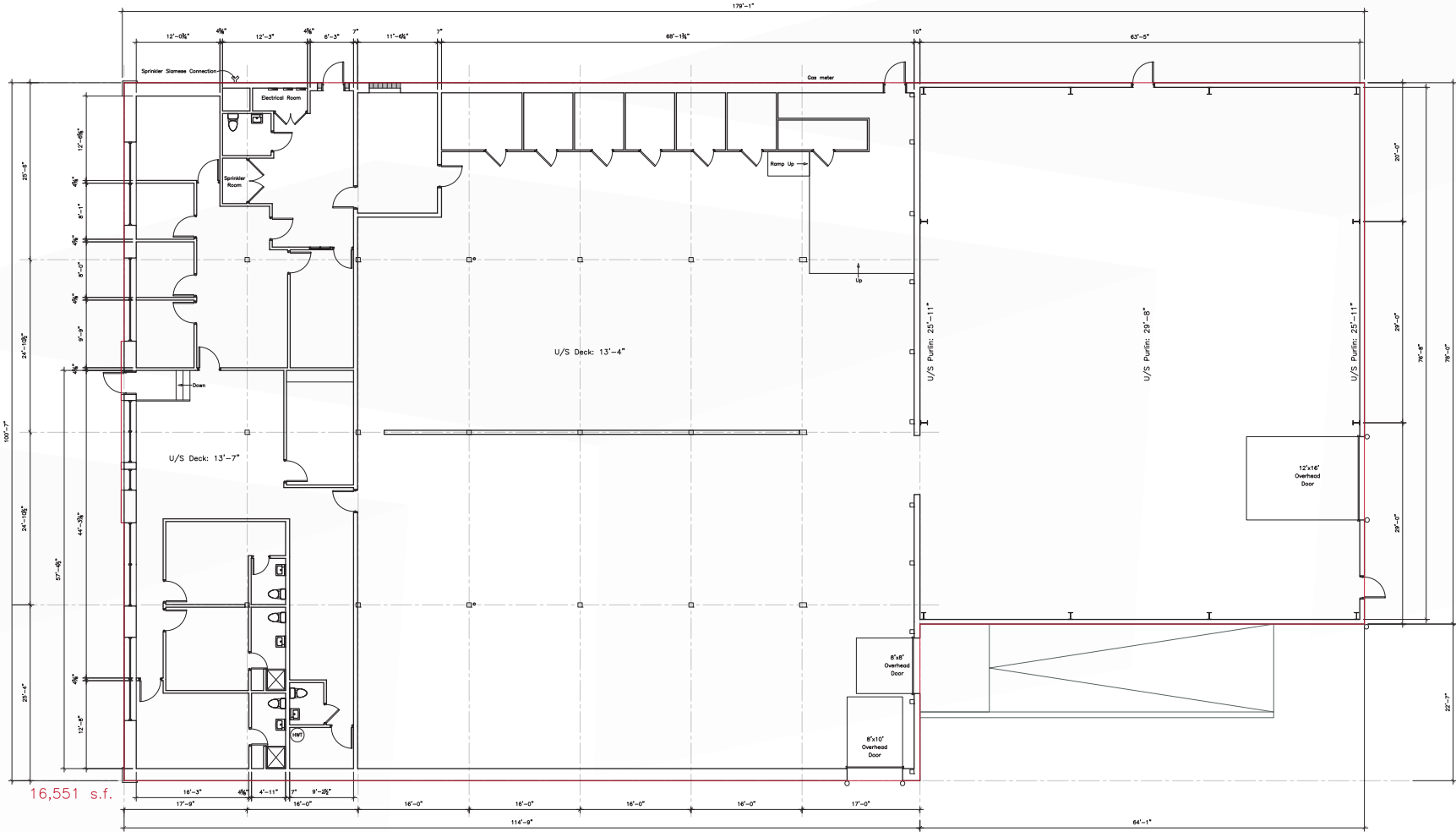

# INTERIOR PHOTOS



# CENTREPORT CANADA

CN RAIL LINE

CP RAIL LINE

Industrial Manufacturing & Logistics

CentrePort Canada Rail Park

Strategic Development

Future Residential

CP RAIL LINE

**MURRAY IND.**

**BROOKPORT BUS. PK.**

**BROOKSIDE BUS. PK.**

**NORTH INKSTER IND.**

**INKSBROOK IND. PK.**

**NORTHWEST BUS. PK.**

**INKSTER IND. PK.**

INKSTER BOULEVARD

**OAK POINT IND.**

**BROOKSIDE IND. PK.**

**WESTON SHOPS**



**OMAND'S CREEK IND.**

**ST. JAMES IND.**

WINNIPEG RICHARDSON INTERNATIONAL AIRPORT

PP POLO PARK

# DRIVE TIME ANALYSIS



RICHARDSON INT'L AIRPORT  
*7 minutes*



POLO PARK SHOPPING CENTRE  
*8 minutes*



PORTAGE AND MAIN  
*11 minutes*



CENTREPORT CANADA  
*11 minutes*



## CONTACT

ERIC OTT, Vice President, Sales & Leasing

(204) 985-1378

[eric.ott@capitalgrp.ca](mailto:eric.ott@capitalgrp.ca)

*Services provided by Eric A. Ott Personal Real Estate Corporation*

MARIO POSILLIPO, Senior Advisor, Sales & Leasing

(204) 985-1373

[mario.posillipo@capitalgrp.ca](mailto:mario.posillipo@capitalgrp.ca)

## CAPITAL COMMERCIAL REAL ESTATE SERVICES INC.

300-570 Portage Avenue, Winnipeg, MB R3C 0G4 | T (204) 943-5700 | F (204) 956-2783 | [capitalgrp.ca](http://capitalgrp.ca)

Disclaimer: Capital Commercial Real Estate Services Inc. ("Capital") does not accept or assume any responsibility or liability, direct or consequential, for the information set out herein, including, without limitation, any projections, images, opinions, assumptions and estimates obtained from third parties. This information has not been verified by Capital, and Capital does not guarantee the accuracy, correctness and completeness of this information. The recipient of this information should take such steps as the recipient may deem necessary to verify the information in this document prior to placing any reliance upon it. The information may change and any property described in this document may be withdrawn from the market at any time without notice or obligation to the recipient from Capital.