

NEWLY BUILT FLEX SPACE IN HEADINGLEY FOR LEASE



5 Fast Lane

HEADINGLEY, MB



DAWSON GROENING, Advisor, Sales & Leasing
(204) 985-1383
dawson.groening@capitalgrp.ca

GARY GOODMAN, Vice President, Sales & Leasing
(204) 997-4831
gary.goodman@capitalgrp.ca

PROPERTY OVERVIEW

PROPERTY DETAILS

| UNIT 3 | |
|-----------------------------|---|
| AREA AVAILABLE (+/-) | Main Floor: 2,400 sq. ft. |
| | Mezzanine: 720 sq. ft. |
| | Total: 3,120 sq. ft. |
| NET RENTAL RATE | \$14.75 per sq. ft. |
| ADDITIONAL RENT | \$4.67 per sq. ft. <i>plus mgmt. fee of 5% of Base Rent</i> |
| LOADING | 1 Grade Level Door (12' wide x 14' high) |
| ELECTRICAL | 200 Amp, 3 Phase |
| ZONING | IB - Industrial Business Zone |
| YEAR BUILT | 2023 |

PROPERTY HIGHLIGHTS

- Pre-engineered steel construction
- Finished washroom
- Excellent visibility from Perimeter Highway
- Proximity to Perimeter Highway, Wilkes Avenue, and Roblin Boulevard
- No City of Winnipeg Business Tax

LOCATION OVERVIEW



SITE PLAN

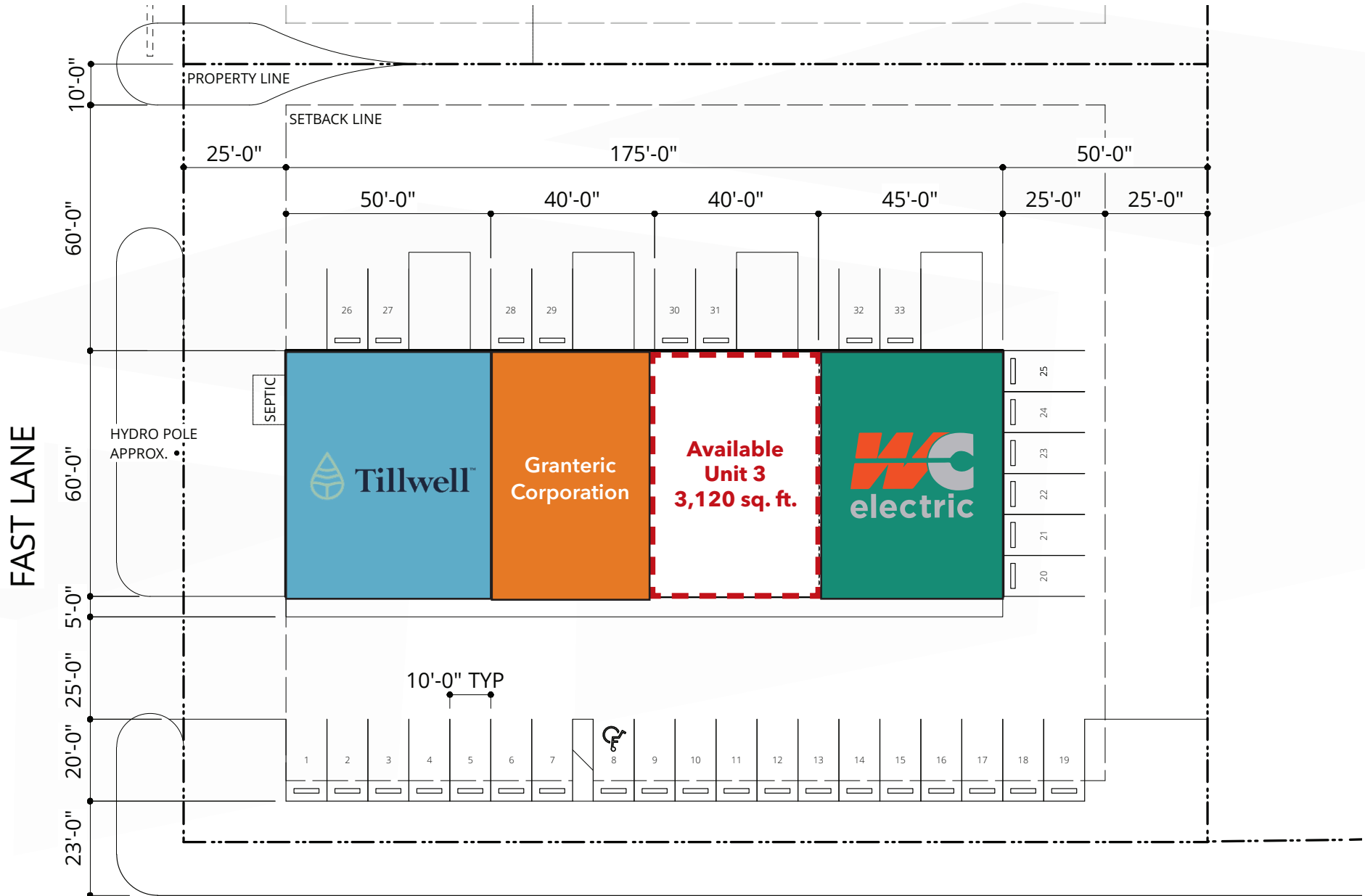

INTERIOR PHOTOGRAPHS



LOCATION AERIAL



Taylor Farms
585 new homes

5 Fast Lane is strategically located just west of the Perimeter Highway with excellent access to Roblin Boulevard and future connectivity from Wilkes Avenue, making it ideal for a wide variety of users. Also along the West Perimeter Highway, new and emerging industrial developments near Wilkes Avenue and adjacent Headingley are reinforcing the corridor's role as a high-growth employment area, benefiting from strong transportation links, available serviced land, and proximity to Winnipeg's west-side residential growth. There are currently over 1,000 homes recently built within 5km of the property and another 671 homes in the planning stages and expected to be completed in the next five years.

Forest Grove
86 homes in Phase 1

Ridgewood West
789 new homes









GLENDALE
 GOLF & COUNTRY CLUB











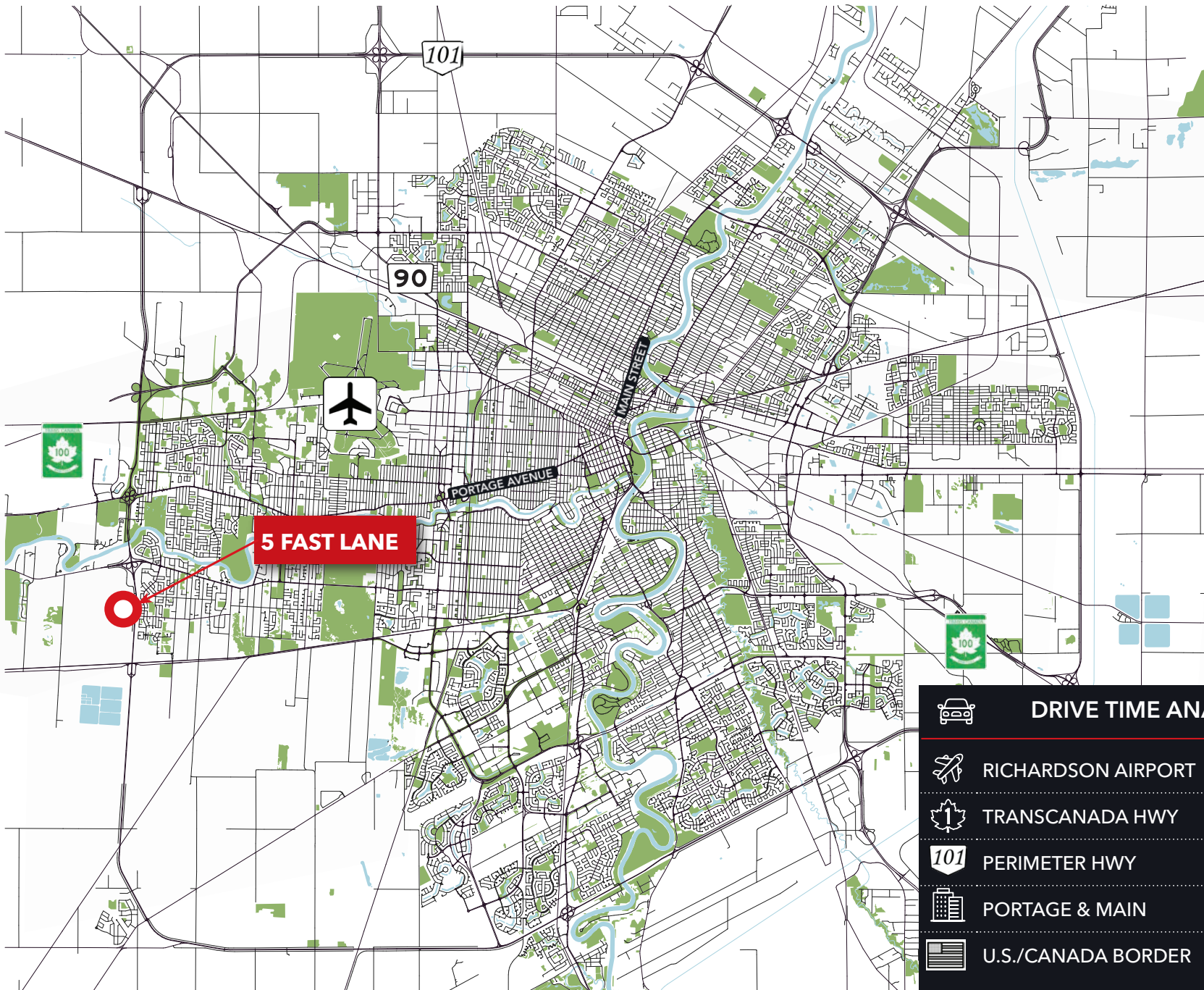



LOCATION OVERVIEW



|  | DRIVE TIME ANALYSIS | |
|---|---------------------|-------------------|
|  | RICHARDSON AIRPORT | 22 min. / 15.1 km |
|  | TRANSCANADA HWY | 5 min. / 5.2 km |
|  | PERIMETER HWY | 1 min. / 0.2 km |
|  | PORTAGE & MAIN | 29 min. / 18.2 km |
|  | U.S./CANADA BORDER | 77 min. / 103 km |

Contact

DAWSON GROENING, Advisor, Sales & Leasing

(204) 985-1383

dawson.groening@capitalgrp.ca

GARY GOODMAN, Vice President, Sales & Leasing

(204) 997-4831

gary.goodman@capitalgrp.ca

CAPITAL COMMERCIAL REAL ESTATE SERVICES INC.

300-570 Portage Avenue, Winnipeg, MB R3C 0G4 | T (204) 943-5700 | F (204) 956-2783 | capitalgrp.ca

Disclaimer: Capital Commercial Real Estate Services Inc. ("Capital") does not accept or assume any responsibility or liability, direct or consequential, for the information set out herein, including, without limitation, any projections, images, opinions, assumptions and estimates obtained from third parties. This information has not been verified by Capital, and Capital does not guarantee the accuracy, correctness and completeness of this information. The recipient of this information should take such steps as the recipient may deem necessary to verify the information in this document prior to placing any reliance upon it. The information may change and any property described in this document may be withdrawn from the market at any time without notice or obligation to the recipient from Capital.